

SHEET 2

SHEET 6
INSET 2

SHEET 3

SHEET 6
INSET 3

SHEET 4

SHEET 6
INSET 1

SHEET 5

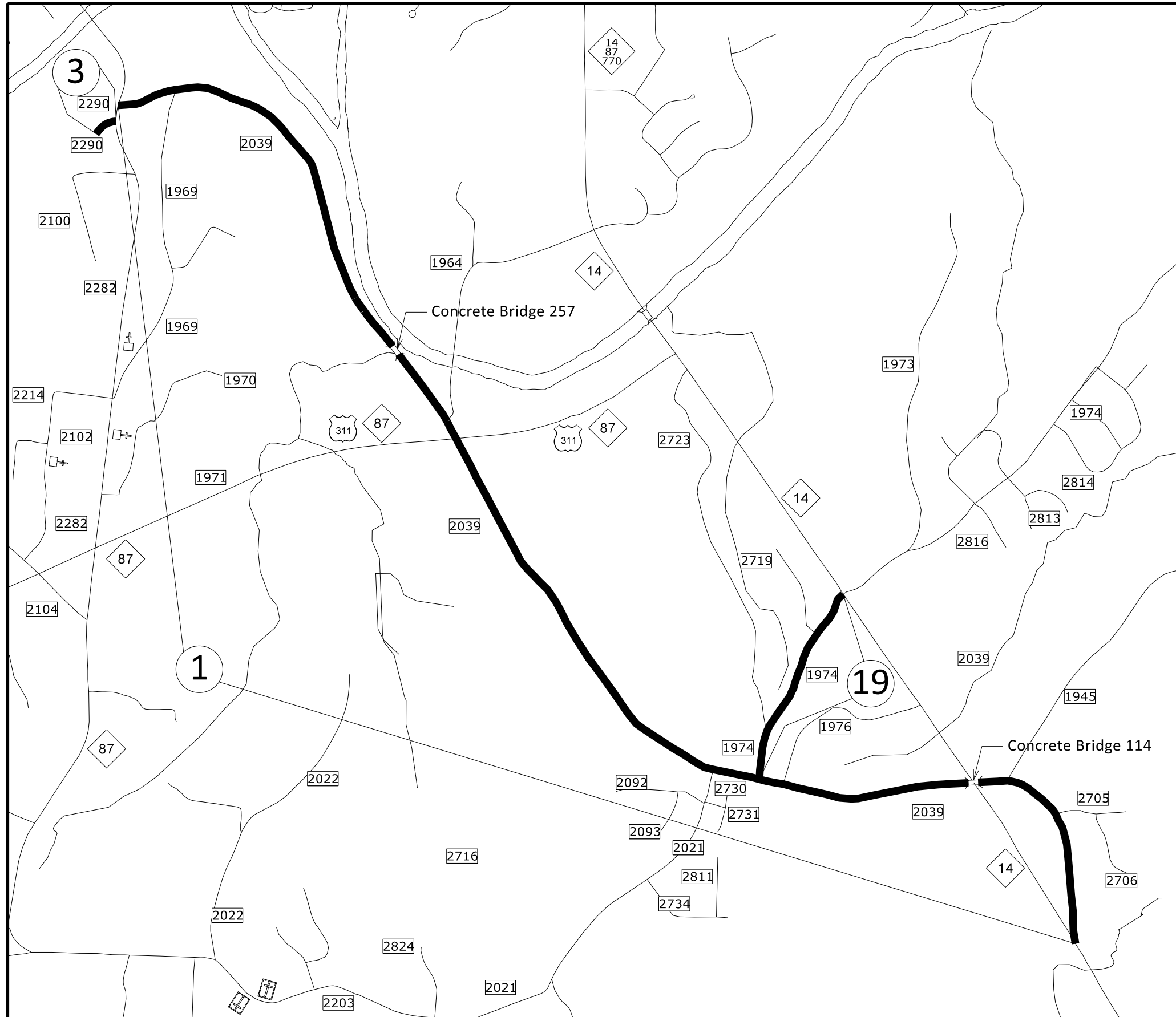

Map 1 SR 2039 Bethlehem Church Rd
Map 3 SR 2290 Mountain Laurel Tr
Map 19 SR 1974 Town Creek Rd

*Do not pave any Concrete Bridge (#257 & #114)

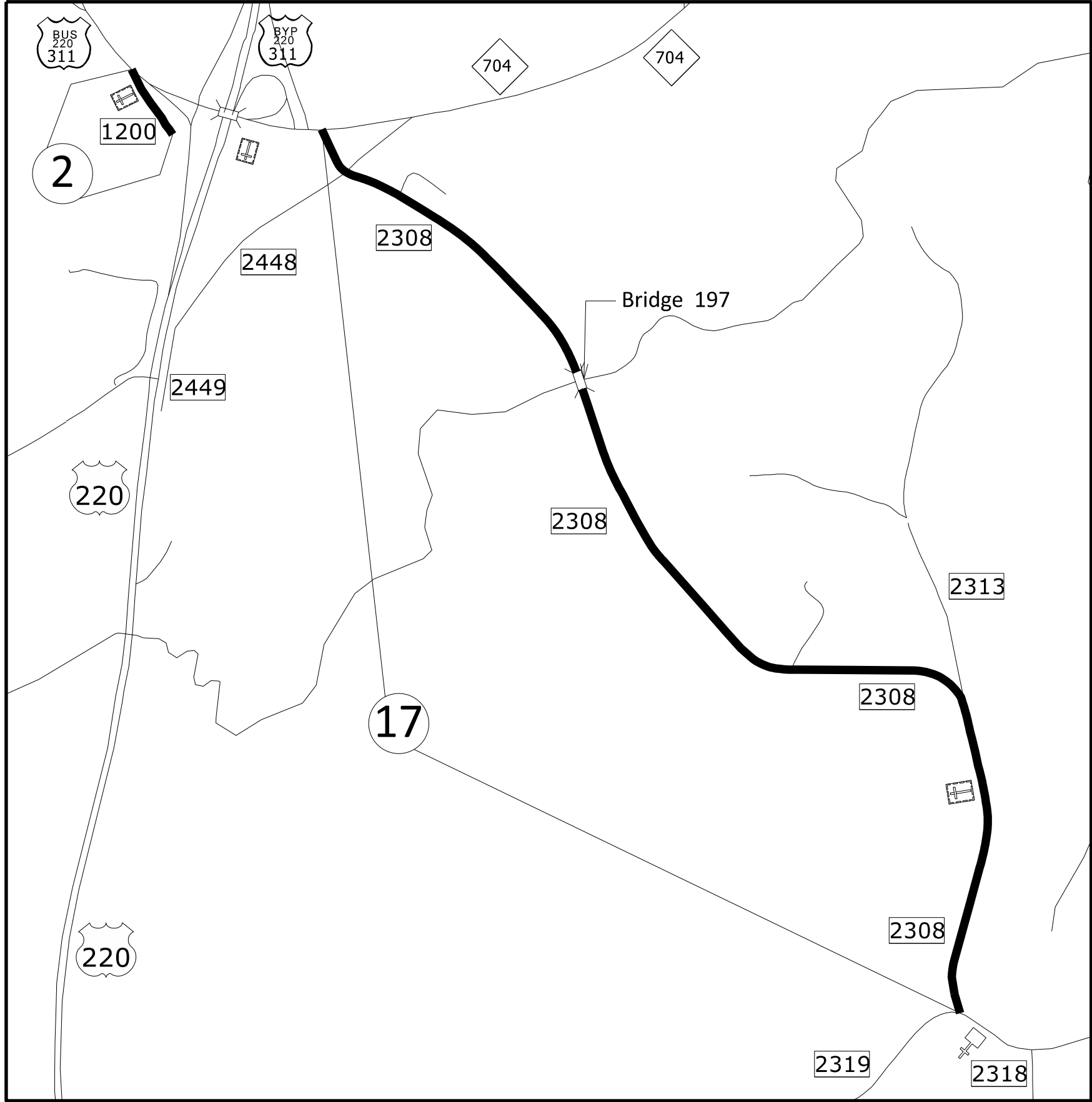

Map 2 SR 1200 Wilbert Dr
Map 17 SR 2308 Bald Hill Lp
* Do Not Pave Bridge 197

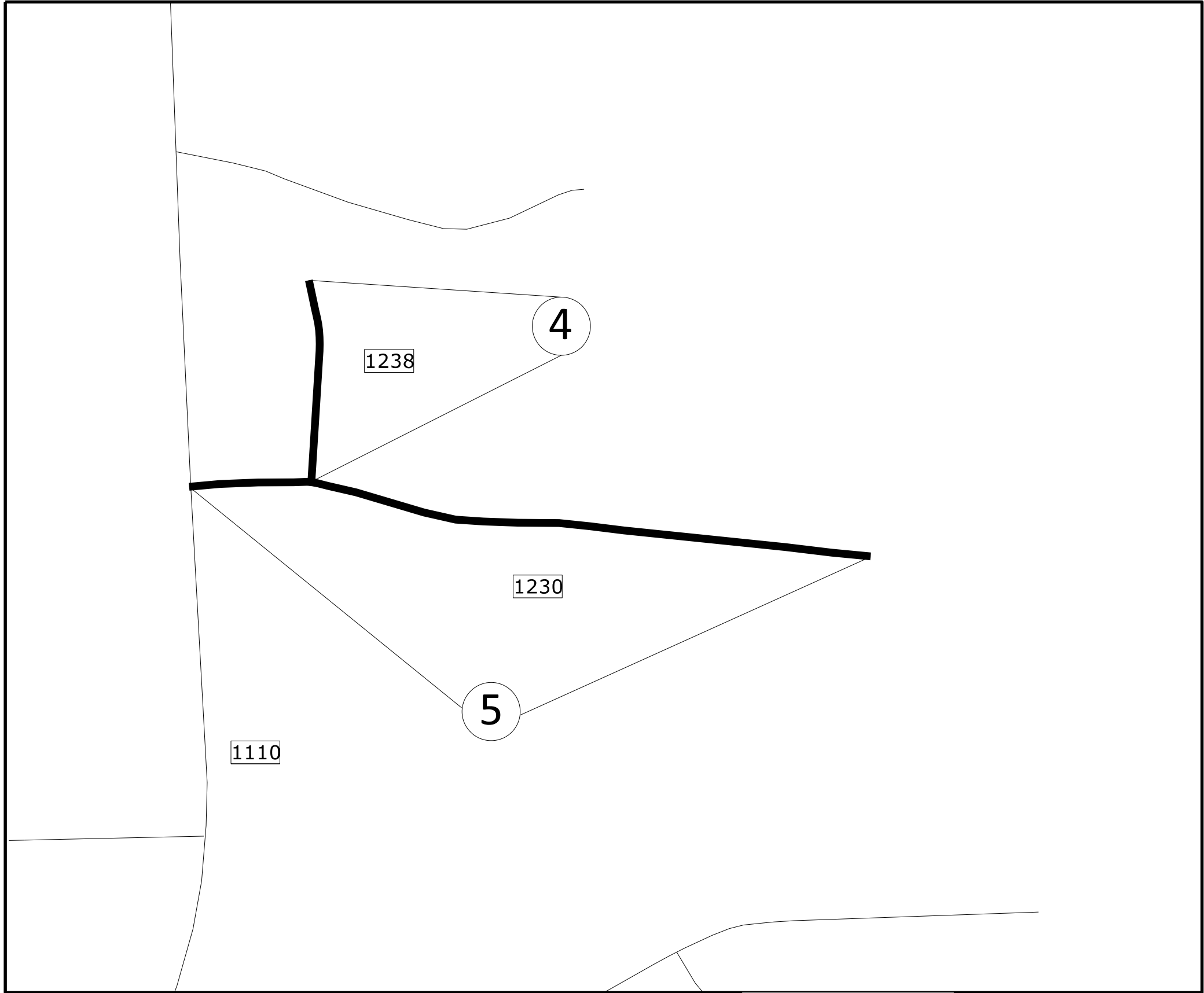

Map 4 SR 1238 Picnic Pl
Map 5 SR 1230 Friends Farm Wy

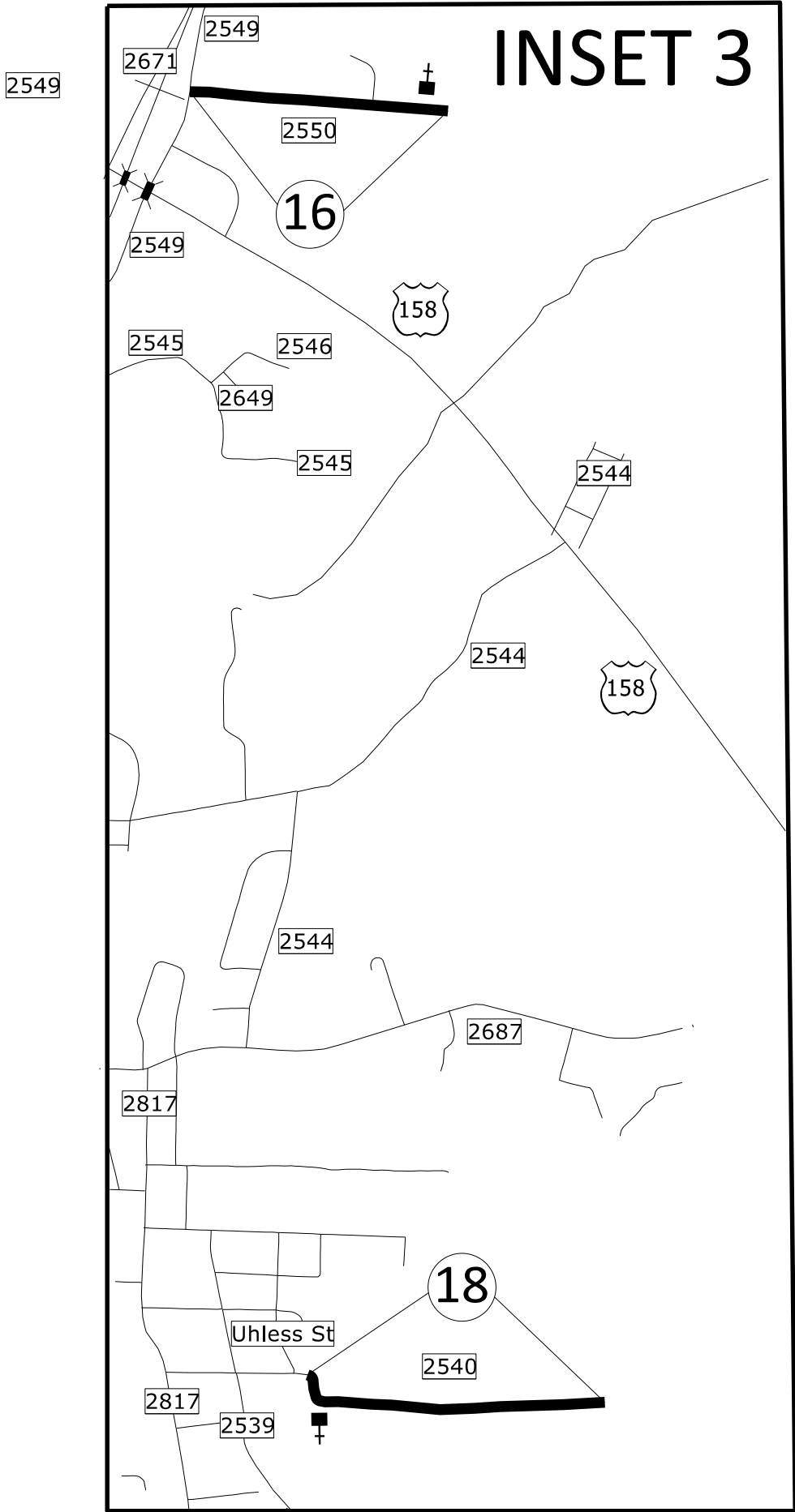
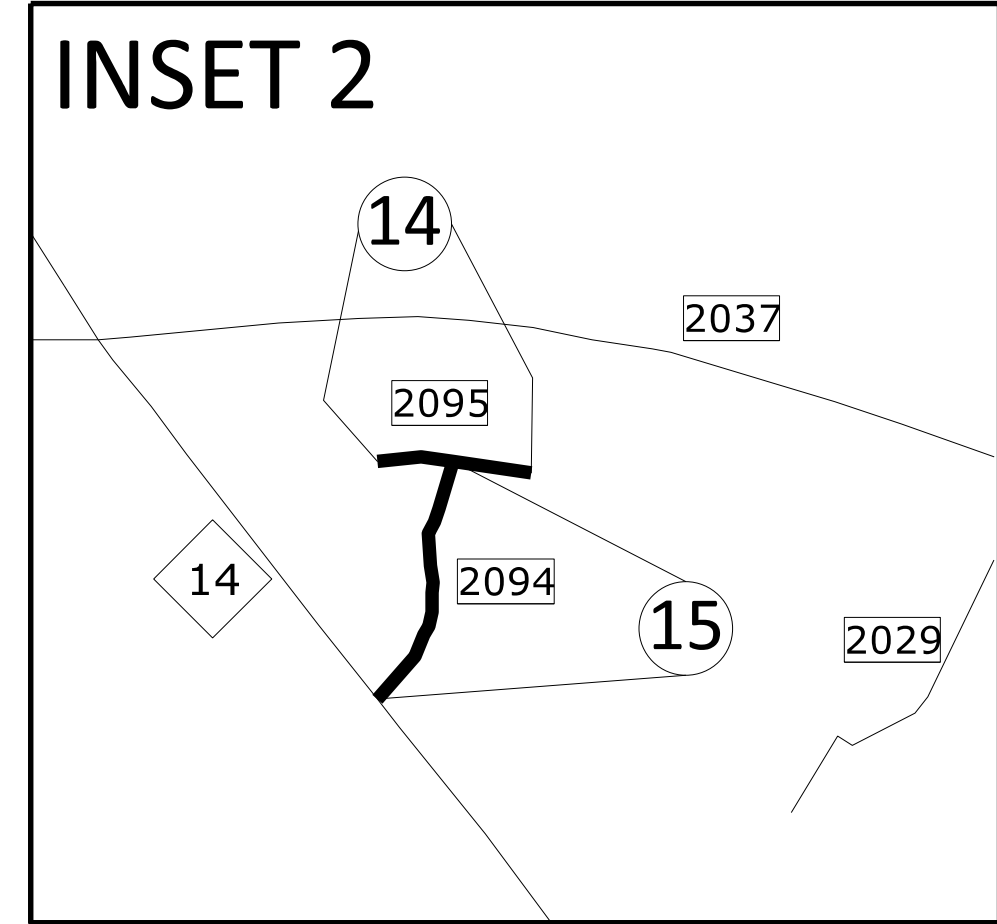
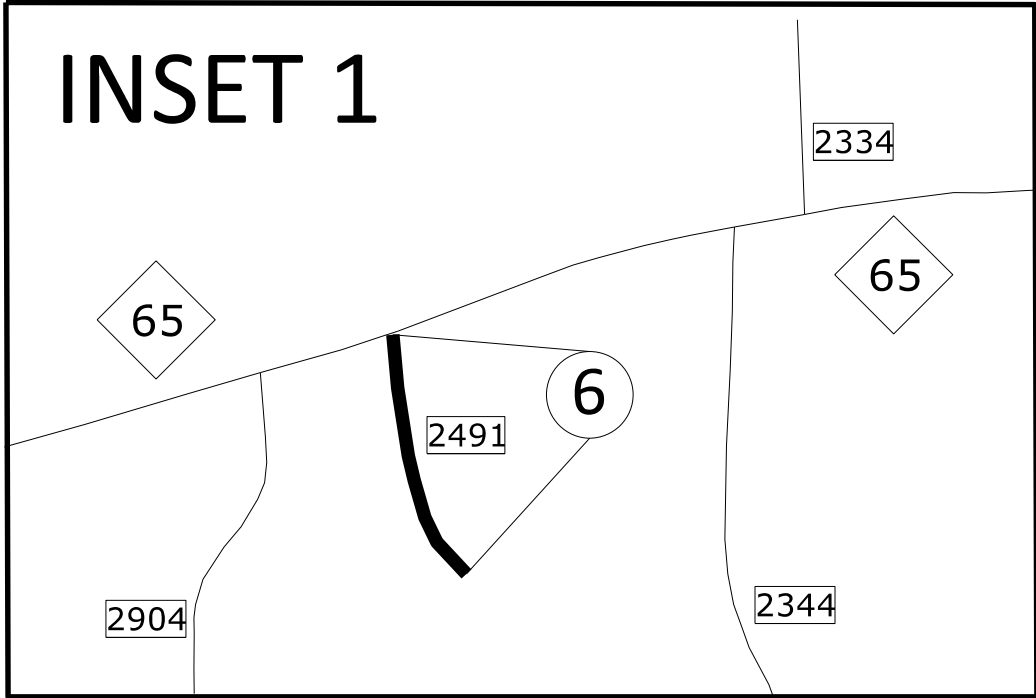

- INSET 1**
Map 6 SR 2491 Alley Farm Rd
- INSET 2**
Map 14 SR 2095 Merrigold Rd
Map 15 SR 2094 Tinderbox Rd
- INSET 3**
Map 16 SR 2550 Penn Lake Dr
Map 18 SR 2540 Walker St

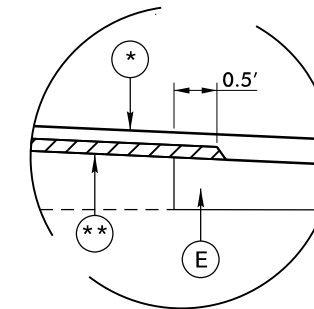
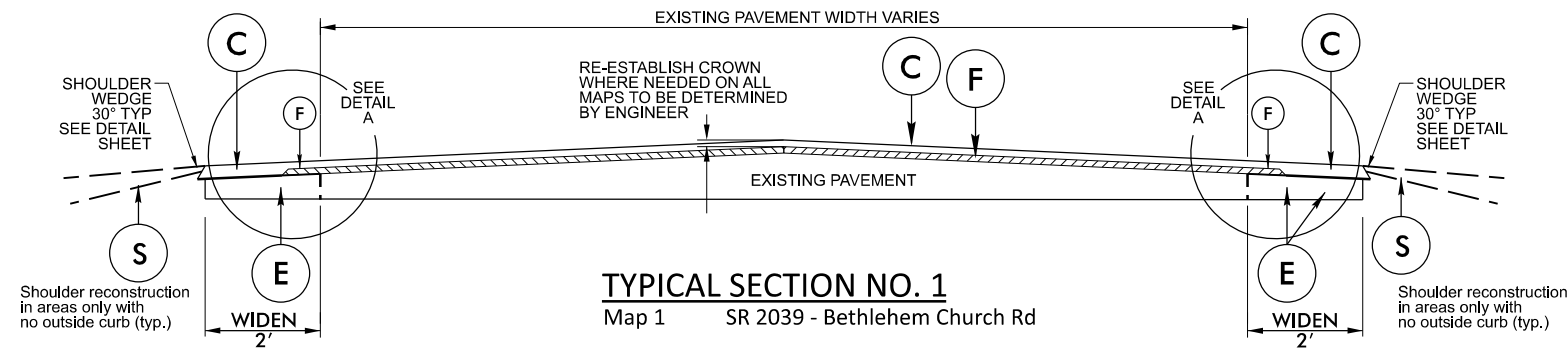

DETAIL A

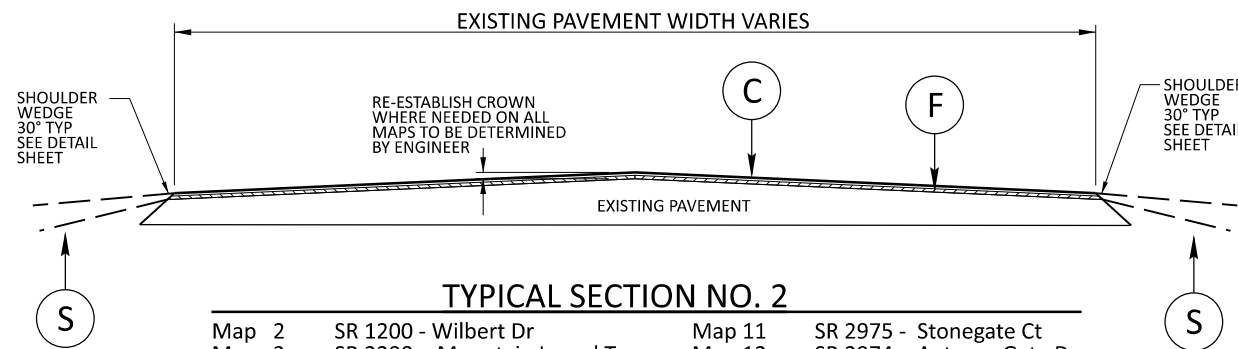

Map 2	SR 1200 - Wilbert Dr	Map 11	SR 2975 - Stonegate Ct
Map 3	SR 2290 - Mountain Laurel Tr	Map 12	SR 2974 - Autumn Gate Dr
Map 4	SR 1238 - Picnic Pl	Map 13	SR 2954 - Stonehaven Ct
Map 5	SR 1230 - Friends Farm Wy	Map 14	SR 2095 - Merrigold Rd
Map 6	SR 2491- Alley Farm Rd	Map 15	SR 2094 - Tinderbox Rd
Map 7	SR 2994 - Wild Fern Ln	Map 16	SR 2550 - Penn Lake Dr
Map 8	SR 2987 - Stillwater Ln	Map 17	SR 2308 - Bald Hill Loop
Map 9	SR 2986 - Laurel Ridge Ct	Map 19	SR 1974 - Town Creek Rd
Map 10	SR 1976 - Meadow Bluff Ct		

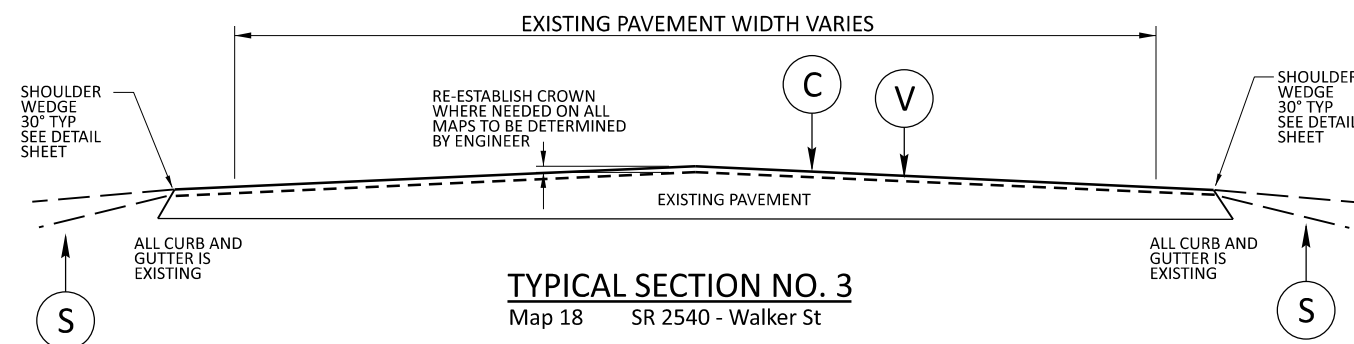

PAVEMENT SCHEDULE

C	PROP. APPROX. 1½" ASPHALT CONCRETE SURFACE COURSE, TYPE S9.5B, TO BE APPLIED AT AN AVERAGE RATE OF 165 LBS PER SQ. YD.
E	PROP. APPROX. 8" ASPHALT CONCRETE BASE COURSE, TYPE B25.0C, AT AN AVERAGE RATE OF 456 LBS. PER SQ. YD. IN EACH OF TWO LAYERS.
F	AST MAT COAT, #78M
S	SHOULDER RECONSTRUCTION (SEE DETAIL)
V	MILL ASPHALT PAVEMENT, 1½" DEPTH

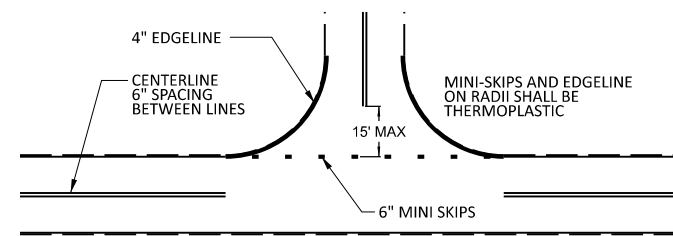

NOTE: MINI SKIPS SHALL BE PLACED ON A 8' CYCLE, CONTAINING A 6' AND 2' SKIP, THE WIDTH OF THE SKIP SHALL BE 6".

**TO BE USED AT ALL
NON-SIGNALIZED INTERSECTIONS**
(NOT TO SCALE)

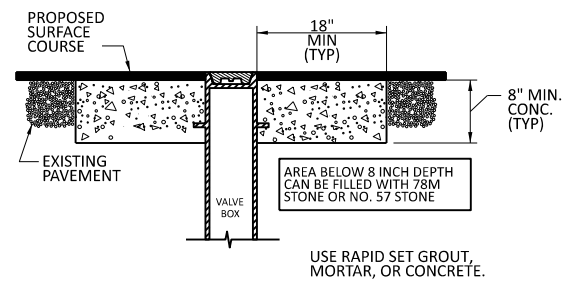

**STANDARD CONCRETE ENCASMENT FOR
VALVE CASTINGS IN PAVEMENT**

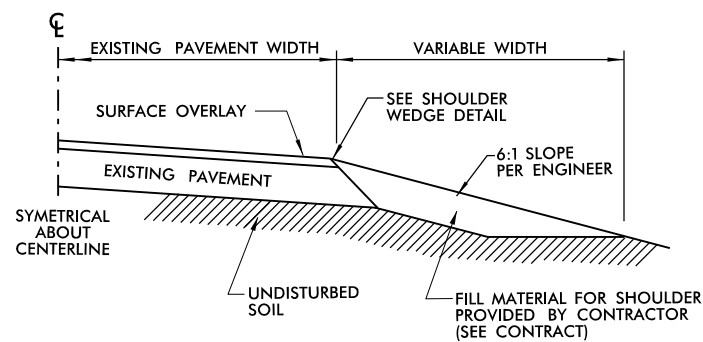

SHOULDER RECONSTRUCTION
* PLACE ASB OR BORROW AS DIRECTED BY THE ENGINEER

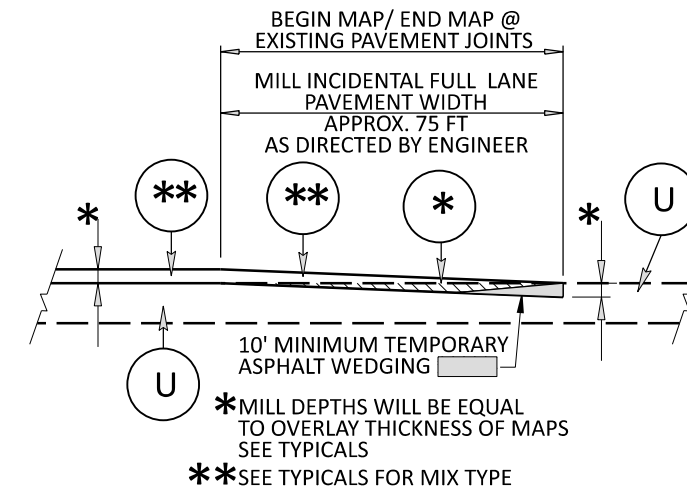

INCIDENTAL MILLING AT TIE-IN DETAIL

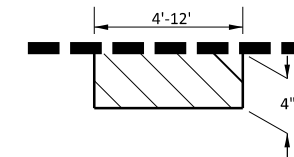

PATCH WITH ACSC, ACIC OR ACBC AS DIRECTED BY THE ENGINEER

**PATCHING EXISTING
PAVEMENT DETAIL**

PAVEMENT SCHEDULE	
C	PROP. APPROX. 1½" ASPHALT CONCRETE SURFACE COURSE, TYPE S9.5B, TO BE APPLIED AT AN AVERAGE RATE OF 165 LBS PER SQ. YD.
E	PROP. APPROX. 8" ASPHALT CONCRETE BASE COURSE, TYPE B25.0C, AT AN AVERAGE RATE OF 456 LBS. PER SQ. YD. IN EACH OF TWO LAYERS.
F	AST MAT COAT, #78M
S	SHOULDER RECONSTRUCTION (SEE DETAIL)
V	MILL ASPHALT PAVEMENT, 1½" DEPTH

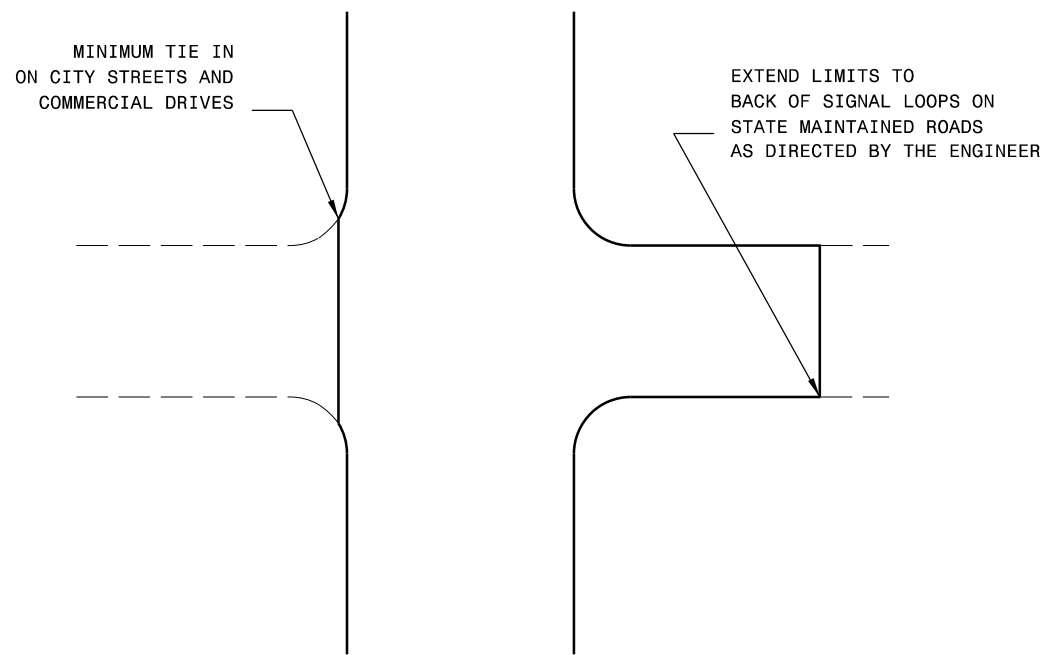

TYPICAL DETAIL OF PROJECT LIMITS AT SIGNALIZED Y LINES

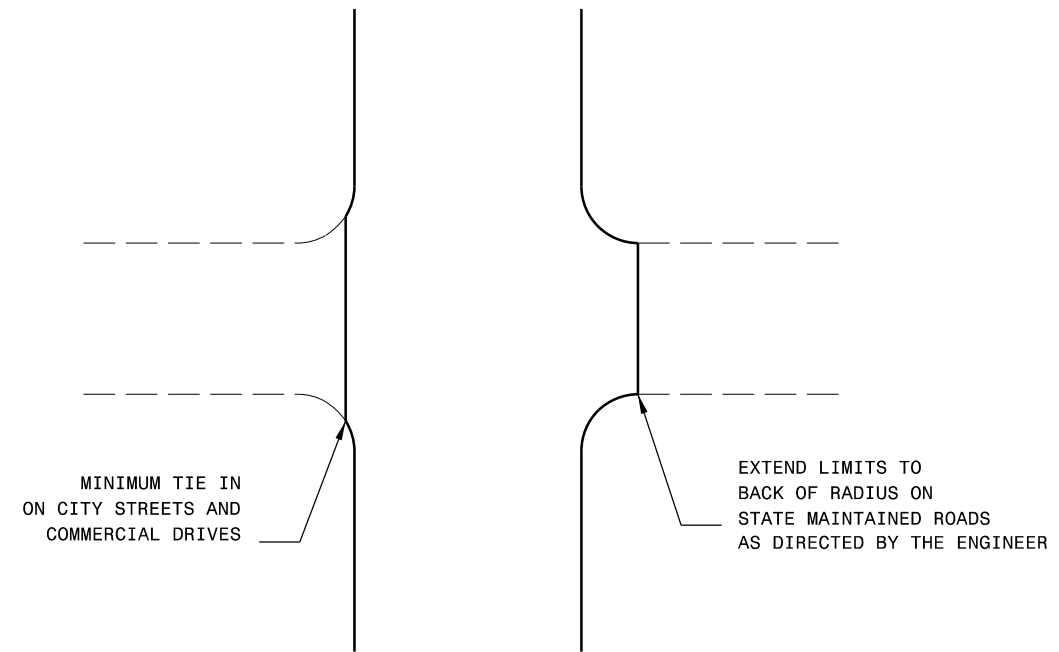

TYPICAL DETAIL OF PROJECT LIMITS AT UNSIGNALIZED Y LINES

ADDITIONAL INTERSECTIONS (NON-TYPICAL)		
Extend paving limits to back of radius or loop on the following intersections:		
MAP#	STREET NAME	COMMENTS
Map 1	SR 2039 - Bethlehem Church Rd	Pave All Intersections to Back of Radius
Map 5	SR 1230 - Friends Farm Wy	Pave All Intersections to Back of Radius
Map 6	SR 2491 - Alley Farm Rd	Pave All Intersections to Back of Radius
Map 7	SR 2994 - Wild Fern Ln	Pave All Intersections to Back of Radius
Map 8	SR 2987 - Stillwater In	Pave All Intersections to Back of Radius
Map 10	SR 2976 - Meadow Bluff Ct	Pave All Intersections to Back of Radius
Map 12	SR 2974 - Autumn Gate Dr	Pave All Intersections to Back of Radius
Map 14	SR 2095 - Merrigold Rd	Pave All Intersections to Back of Radius
Map 17	SR 2308 - Bald Hill Lp	Pave All Intersections to Back of Radius
Map 18	SR 2540 - Walker St	Pave All Intersections to Back of Radius
Map 19	SR 1974 - Town Creek Rd	Pave All Intersections to Back of Radius

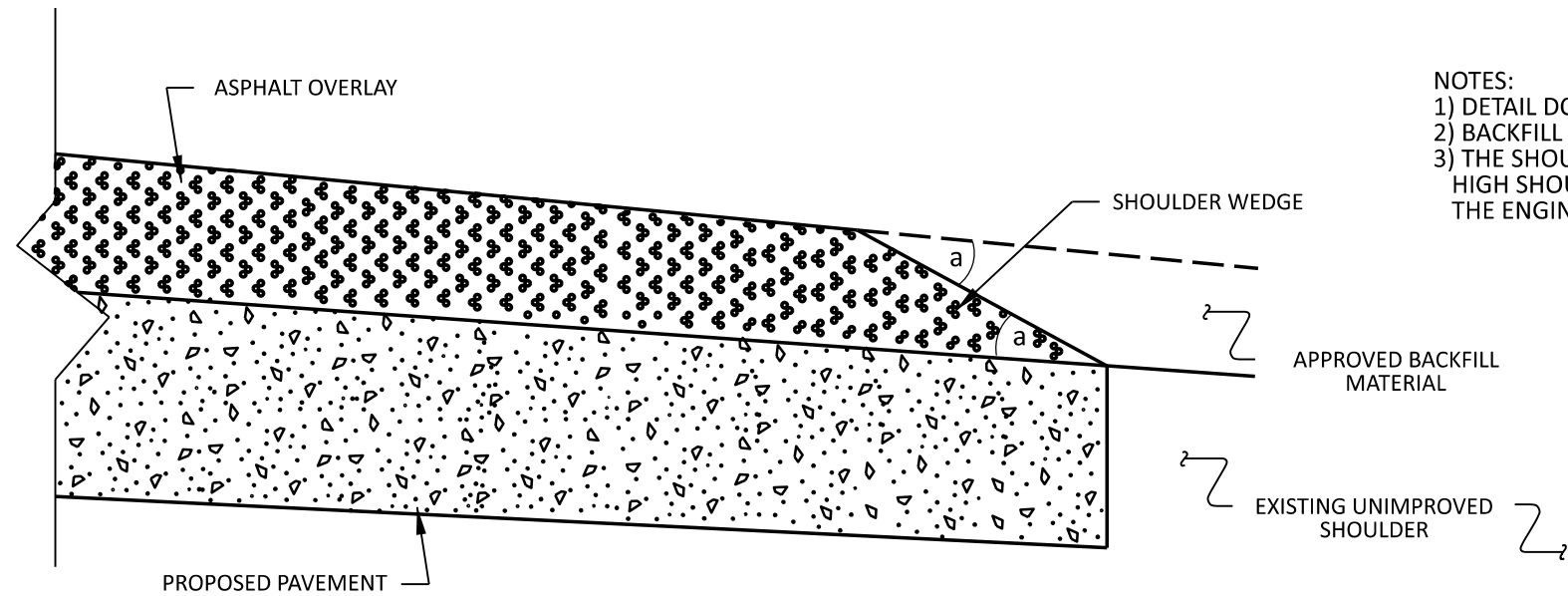

NOTES:
 1) DETAIL DOES NOT APPLY TO OGAFC AND ULTRA-THIN BONDED WEARING COURSE.
 2) BACKFILL SHOULDER WITH APPROVED MATERIAL.
 3) THE SHOULDER WEDGE DEVICE MAY BE DISENGAGED AT PAVED DRIVEWAYS AND SIDE STREETS, HIGH SHOULDERS, AND OTHER LOCATIONS NOT FEASIBLE TO CONSTRUCT AS DIRECTED BY THE ENGINEER.

SHOULDER WEDGE DETAIL
 (Resurfacing Projects w/ Widening or with Existing Paved Shoulder having no dropoffs)

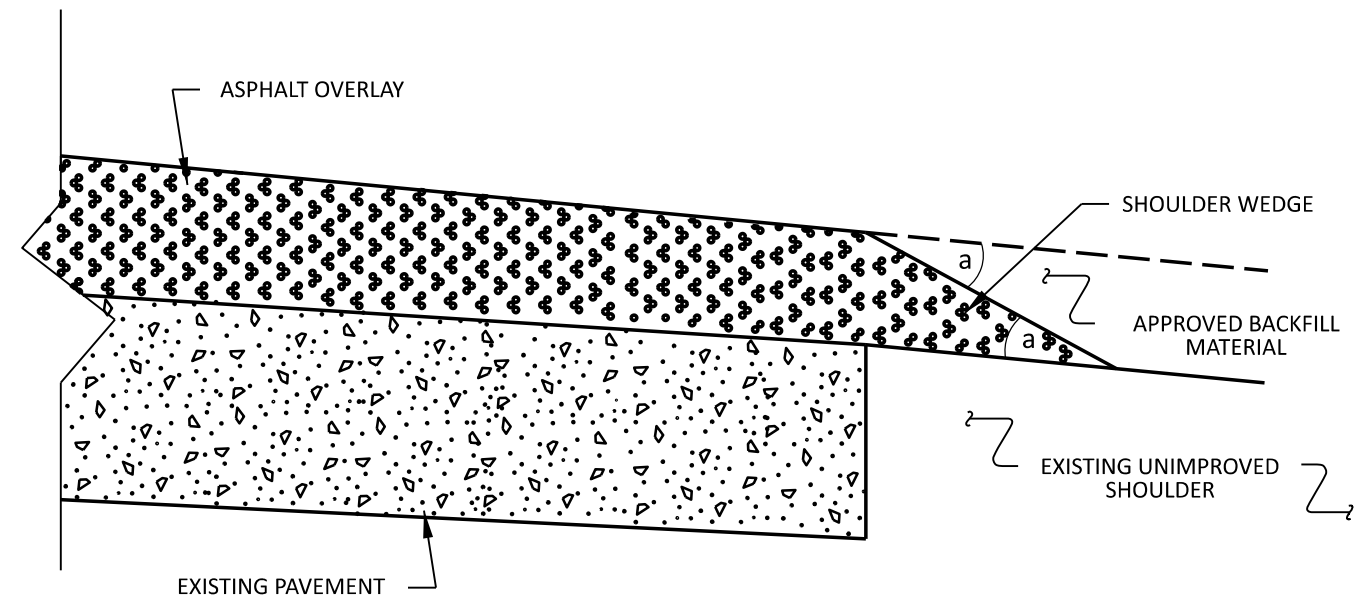

SHOULDER WEDGE DETAIL
 (Resurfacing Projects w/ NO Widening)

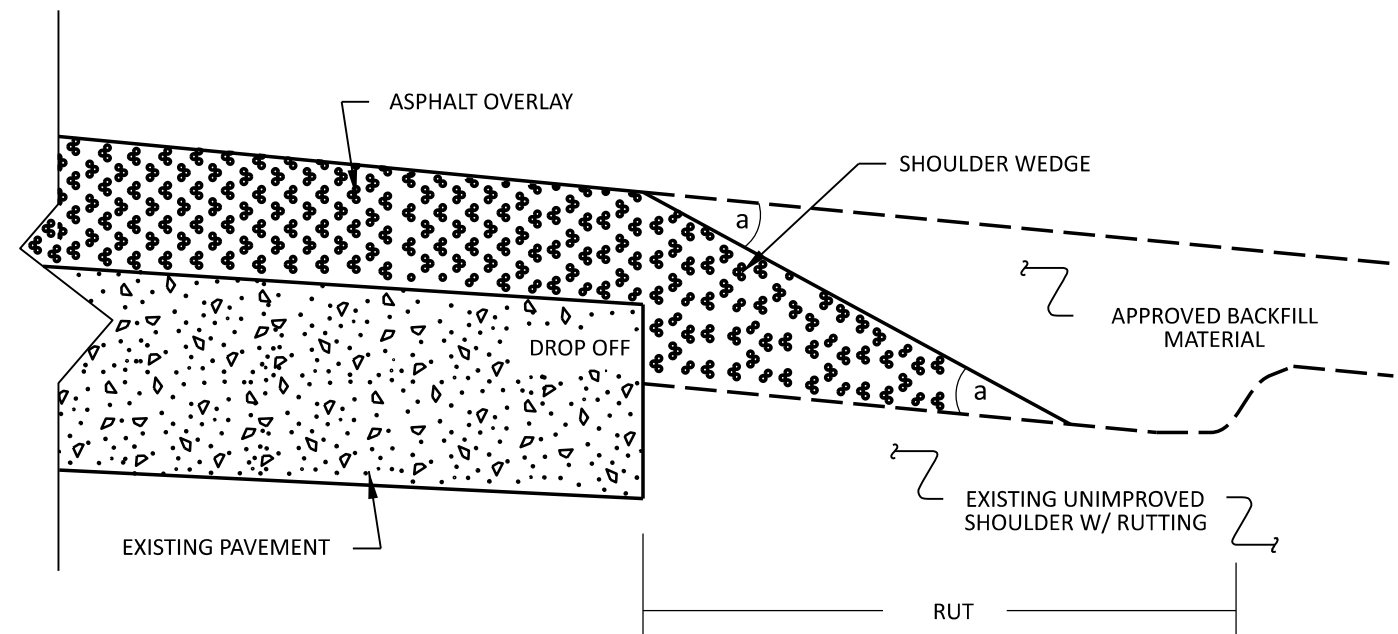

SHOULDER WEDGE DETAIL
 (Resurfacing Adjacent to Rutted Shoulder)

- SHOULDER WEDGE ANGLE = 30°

CONTRACT STANDARDS AND DEVELOPMENT UNIT Office 919-707-6950 FAX 919-250-4119			
SHOULDER WEDGE DETAILS			
ORIGINAL BY:	T.SPELL	DATE:	7-19-11
MODIFIED BY:		DATE:	10/16/12
CHECKED BY:		DATE:	
FILE SPEC.:	susr/details/stand/shoulderwedgedetail.dgn		

NOTES: Less than 5' - 10' undisturbed buffer from ROW, ditchline, water feature, or drainage inlet, add BMP.

BMP Options: Wattle or Silt Fence

EROSION CONTROL DETAIL

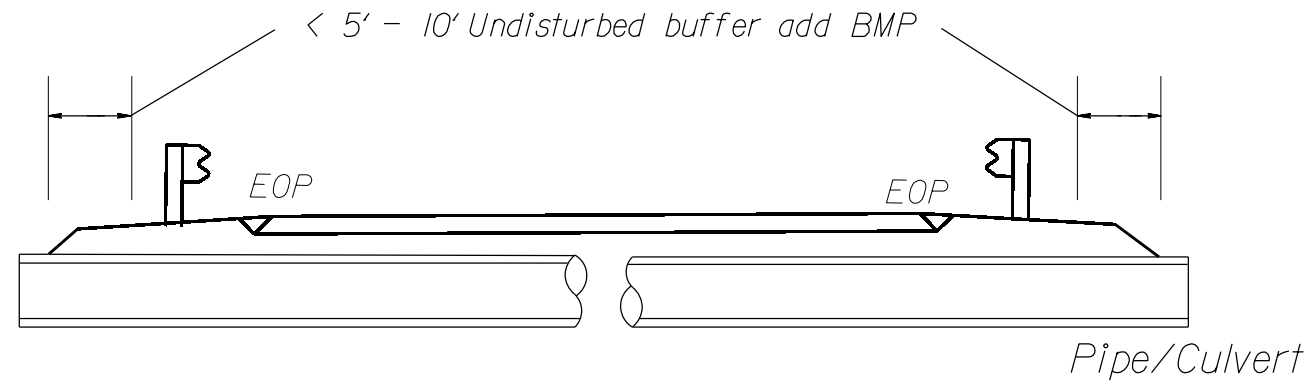

< 5' - 10' Undisturbed buffer from jurisdictional feature add BMP

< 5' - 10' Undisturbed buffer from ditchline, add BMP

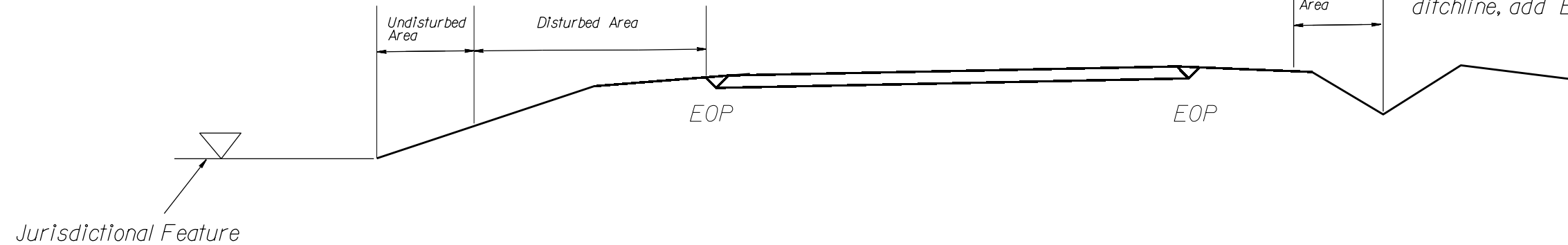

Use BMP's if berms, shoulders and/or frontslopes and/or ditchline and/or backslopes are disturbed

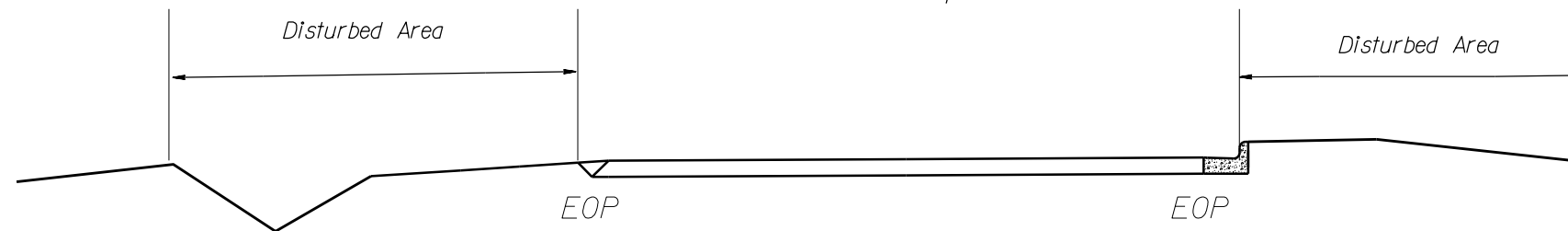

< 5' - 10' Undisturbed buffer from inlet, add wattle

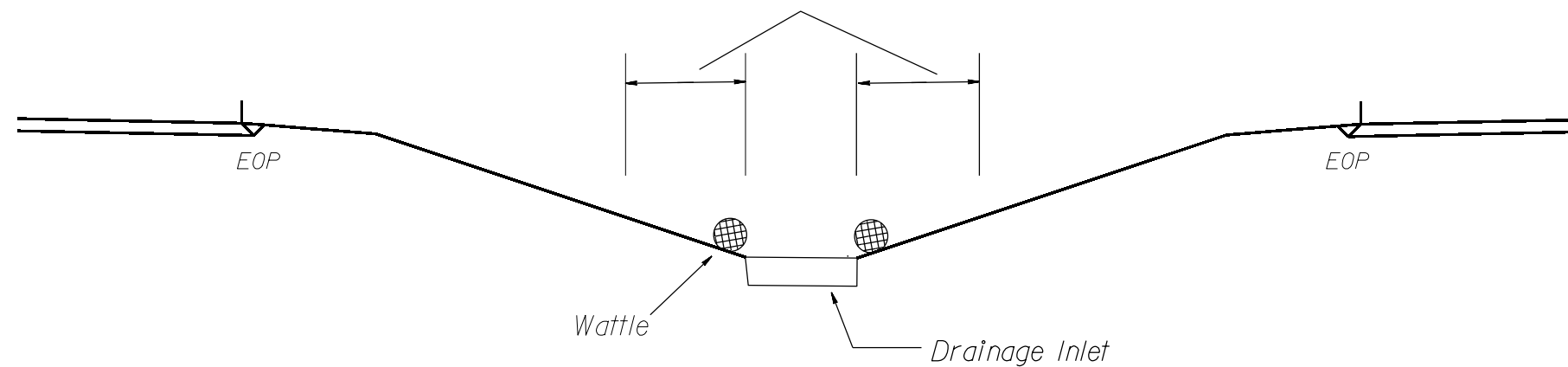

NOT TO SCALE

SIGNING FOR RESURFACING PROJECTS

LEGEND

┃ STATIONARY SIGN

← DIRECTION OF TRAFFIC FLOW

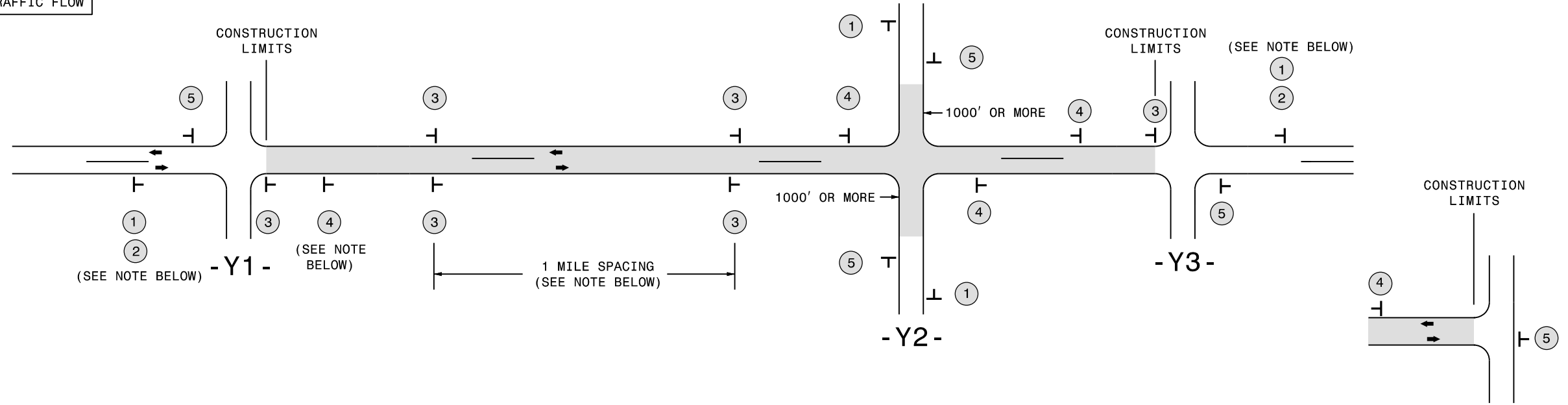

MAINLINE (-L-) SIGNING

-Y- LINE SIGNING

SIGNING NOTES AND PLACEMENT PER DIRECTION	<p>1</p> <p>2</p>	<p>PLACE 1000' PRIOR TO BEGINNING OF CONSTRUCTION LIMITS. ONLY USED ON -Y- LINES IF RESURFACING LIMITS EXTEND 1000' ALONG -Y- LINE.</p> <p>#2 SIGN ONLY USED WHEN CONSTRUCTION LIMITS ARE 2 OR MORE MILES IN LENGTH. ROUND UP TO NEXT WHOLE NUMBER. (NO FRACTIONAL OR DECIMAL NUMBERS)</p>	<p>NO REQUIRED STATIONARY SIGNING FOR THE FOLLOWING -Y- LINE CONDITIONS:</p> <ol style="list-style-type: none"> LESS THAN 1000' OF RESURFACING ALONG -Y- LINE SUBDIVISION ROADS DEAD END ROADS <p>WHEN PAVING/CONSTRUCTION ACTIVITIES PROCEED ACROSS AN UNSIGNED -Y- LINE, PORTABLE ADVANCE WARNING SIGNS SHALL BE USED ALONG THE -Y- LINE AS SHOWN BELOW. REMOVE UPON COMPLETION OF WORK.</p> <div style="display: flex; justify-content: space-around;"> <div> <p>PLACED 500' IN ADVANCE OF FLAGGER.</p> </div> <div> <p>PLACED 250' IN ADVANCE OF FLAGGER.</p> </div> </div>
	<p>3</p>	<p>- PLACE INITIALLY AT THE CONSTRUCTION LIMITS AND SPACE 1 MILE APART THEREAFTER.</p> <p>- AT TEE INTERSECTIONS INSTALL INITIALLY 1/2 MILE FROM INTERSECTION AND SPACE 1 MILE APART THEREAFTER.</p>	
	<p>4</p>	<p>- THESE ARE FOR -Y- LINES THAT ARE "THROUGH" ROADWAYS. DEAD END AND SUBDIVISION ROADS ARE NOT "THROUGH" ROADWAYS.</p> <p>- INSTALL 500' +/- FROM EACH -Y- LINE APPROACH AS SHOWN ABOVE.</p> <p>- FOR MULTIPLE -Y- LINES THAT ARE SEPARATED BY 0.25 MILES OR LESS, TREAT AS A SINGLE UNIT AND INSTALL WITHIN 500' OF EACH APPROACH.</p> <p>- A MAXIMUM OF 2 SIGN SETS PER MILE. DO NOT INSTALL WHEN -Y- LINES ARE WITHIN 0.5 MILES FROM "END ROAD WORK" SIGN.</p> <p>- FOR TEE INTERSECTIONS, INSTALL WITHIN 500' +/- OF THE INTERSECTION ALONG -L- LINE.</p>	
	<p>5</p>	<p>PLACE 500' FOLLOWING THE END OF CONSTRUCTION LIMITS OR AS SHOWN WHEN WORK ENDS AT A 3-WAY TEE INTERSECTION.</p>	

THE ABOVE SIGNS ARE ALL THAT ARE REQUIRED FOR A CONTRACTOR TO BEGIN A RESURFACING CONTRACT. ANY ADDITIONAL SIGNS REQUESTED BY NCDOT DIVISIONS SHALL BE INSTALLED WITHIN 7 BUSINESS DAYS OF THE START OF CONTRACT WORK.

MAPS LESS THAN 2 MILES

FOR RESURFACING MAPS WITH CONSTRUCTION LIMITS LESS THAN 2 MILES IN LENGTH, NO STATIONARY SIGNS ARE REQUIRED. USE PORTABLE "ROAD UNDER CONSTRUCTION" OR "ROAD WORK AHEAD" SIGNS IN LIEU OF STATIONARY ADVANCE WARNINGS SIGNS.

ADVANCE WARNING SIGNS FOR RURAL AND SUBURBAN 2-LANE ROADWAY RESURFACING

PROJECT NO.	SHEET NO.	TOTAL NO.
2026CPT.07.15.20791	13	13

SUMMARY OF QUANTITIES

PROJECT NO	COUNTY	MAP NO	ROUTE	DESCRIPTION	TYP NO	LENGTH	WIDTH	BEGIN MP	END MP	BORROW EXCAVATION	INCIDENTAL STONE	SHOULDER RECONSTRUCTION	AGGREGATE SHOULDER BORROW	MILLING ASPHALT PAVEMENT, 1 1/2" DEPTH	INCIDENTAL MILLING	ASPHALT CONC BASE COURSE, TYPE B25.0C	ASPHALT CONC SURFACE COURSE, TYPE S9.5B	ASPHALT BINDER FOR PLANT MIX	PATCHING EXISTING PAVEMENT	ASPHALT SURFACE TREATMENT, MAT COAT, #78M STONE	EMULSION FOR ASPHALT SURFACE TREATMENT	ADJUSTMENT OF METER BOXES OR VALVE BOXES	TEMPORARY SILT FENCE	WATTLE	SEEDING & MULCHING	WORK ZONE ADVANCE/ GENERAL WARNING SIGNING	TEMPORARY TRAFFIC CONTROL	6" X 90 M WHITE THERMO	6" X 90 M YELLOW THERMO	24" X 90 M WHITE THERMO	THERMO RT ARROW 90 M		
						MI	FT			CY	TONS	SMI	TON	SY	SY	TON	TONS	TON	TONS	TON	TONS	SY	GAL	EA	LF	LF	AC	SF	LS	LF	LF	LF	EA
2026CPT.07.15.20791	Rockingham	1	SR-2039 / BETHLEHEM CHURCH RD	FROM NC 14 TO SR 2282 - S HAMILTON ST	1	3.940	20	0.000	3.940	446	120	7.44	562		1,667	3,981	5,443	544	230	50,943	16,811		1,576	158	1.62	441		42,000	36,000	50	1		
TOTAL FOR MAP NO. 1						3.940				446	120	7.44	562		1,667	3,981	5,443	544	230	50,943	16,811		1,576	158	1.62	441		42,000	36,000	50	1		
2026CPT.07.15.20791	Rockingham	2	SR-1200 / WILBERT DR	FROM US 220 BUS. TO END MAINT	2	0.120	20	0.000	0.120	5	6	0.25	2		363		160	10		1,760	581		48	5	0.02								
TOTAL FOR MAP NO. 2						0.120				5	6	0.25	2		363		160	10		1,760	581		48	5	0.02								
2026CPT.07.15.20791	Rockingham	3	SR-2290 / MOUNTAIN LAUREL TR	FROM SR 2282 - S HAMILTON ST TO CUL-DE-SAC	2	0.070	21	0.000	0.070	2	6	0.08			175		91	6	6	578	191		28	3	0.01								
TOTAL FOR MAP NO. 3						0.070				2	6	0.08			175		91	6	6	578	191		28	3	0.01								
2026CPT.07.15.20791	Rockingham	4	SR-1238 / PICNIC PL	FROM SR 1230 - FRIENDS FARM WAY TO CUL-DE-SAC	2	0.080	21	0.000	0.080	2		0.15	4				113	8	12	1,250	413		32	3	0.01								
TOTAL FOR MAP NO. 4						0.080				2		0.15	4				113	8	12	1,250	413		32	3	0.01								
2026CPT.07.15.20791	Rockingham	5	SR-1230 / FRIENDS FARM WAY	FROM SR 1110 - ELLISBORO RD TO CUL-DE-SAC	2	0.270	20	0.000	0.270	12		0.53	2		200		348	27	100	3,712	1,225		108	11	0.04								
TOTAL FOR MAP NO. 5						0.270				12		0.53	2		200		348	27	100	3,712	1,225		108	11	0.04								
2026CPT.07.15.20791	Rockingham	6	SR-2491 / ALLEY FARM RD	FROM NC 65 TO DEAD END	2	0.190	18	0.000	0.190	4	24	0.35	8		150		175	14	60	1,863	615		76	8	0.02								
TOTAL FOR MAP NO. 6						0.190				4	24	0.35	8		150		175	14	60	1,863	615		76	8	0.02								
2026CPT.07.15.20791	Rockingham	7	SR-2994 / WILD FERN LN	FROM DEAD END TO SR 2987 - STILLWATER LN	2	0.660	20	0.000	0.660	13	3	1.29	37		583		733	48	8	7,989	2,636		264	26	0.05								
TOTAL FOR MAP NO. 7						0.660				13	3	1.29	37		583		733	48	8	7,989	2,636		264	26	0.05								
2026CPT.07.15.20791	Rockingham	8	SR-2987 / STILLWATER LN	FROM SR 2953 - RIVER RUN DR TO END MAINT	2	0.420	21	0.000	0.420	17		0.83	8		204		486	32	13	5,135	1,694	1	168	17	0.06								
TOTAL FOR MAP NO. 8						0.420				17		0.83	8		204		486	32	13	5,135	1,694	1	168	17	0.06								
2026CPT.07.15.20791	Rockingham	9	SR-2986 / LAUREL RIDGE CT	FROM SR 2974 - AUTUMN GATE DR TO CUL-DE-SAC	2	0.070	21	0.000	0.070	2		0.13	2				100	7	10	1,099	363		28	3	0.01								
TOTAL FOR MAP NO. 9						0.070				2		0.13	2				100	7	10	1,099	363		28	3	0.01								
2026CPT.07.15.20791	Rockingham	10	SR-2976 / MEADOW BLUFF CT	FROM SR 2974 - AUTUMN GATE DR TO CUL-DE-SAC	2	0.150	21	0.000	0.150	8		0.32					220	15	13	2,307	761		60	6	0.03								
TOTAL FOR MAP NO. 10						0.150				8		0.32					220	15	13	2,307	761		60	6	0.03								
2026CPT.07.15.20791	Rockingham	11	SR-2975 / STONEGATE CT	FROM SR 2974 - AUTUMN GATE DR TO CUL-DE-SAC	2	0.040	20	0.000	0.040	2		0.07					68	4		747	246		16	2	0.01								
TOTAL FOR MAP NO. 11						0.040				2		0.07					68	4		747	246		16	2	0.01								
2026CPT.07.15.20791	Rockingham	12	SR-2974 / AUTUMN GATE DR	FROM SR 2953 - RIVER RUN DR TO SR 2976 - MEADOW BLUFF CT	2	0.330	21	0.000	0.330	17		0.66			175		389	25	4	4,108	1,356		132	13	0.06								
TOTAL FOR MAP NO. 12						0.330				17		0.66			175		389	25	4	4,108	1,356		132	13	0.06								
2026CPT.07.15.20791	Rockingham	13	SR-2954 / STONEHAVEN CT	FROM SR 2953 - RIVER RUN DR TO CUL-DE-SAC	2	0.140	21	0.000	0.140	6	3	0.27	1				181	12	6	1,990	657		56	6	0.02								
TOTAL FOR MAP NO. 13						0.140				6	3	0.27	1				181	12	6	1,990	657		56	6	0.02								
2026CPT.07.15.20791	Rockingham	14	SR-2095 / MERRIGOLD RD	FROM CUL-DE-SAC TO DEAD END	2	0.100	20	0.000	0.100	5	3	0.21	1				152	10		1,538	507		40	4	0.02								
TOTAL FOR MAP NO. 14						0.100				5	3	0.21	1				152	10		1,538	507		40	4	0.02								
2026CPT.07.15.20791	Rockingham	15	SR-2094 / TINDERBOX RD	FROM NC 14 TO SR 2095 - MERRIGOLD RD	2	0.160	21	0.000	0.160	4	3	0.25	4		188		140	9	5	1,544	510		64	6	0.02								
TOTAL FOR MAP NO. 15						0.160				4	3	0.25	4		188		140	9	5	1,544	510		64	6	0.02								
2026CPT.07.15.20791	Rockingham	16	SR-2550 / PENN LAKE DR	FROM SR 2549 - NE MARKET ST TO CUL-DE-SAC	2	0.400	18	0.000	0.400	16	66	0.80	8		154		399	26	10	4,398	1,451		160	16	0.06								
TOTAL FOR MAP NO. 16						0.400				16	66	0.80	8		154		399	26	10	4,398	1,451		160	16	0.06								
2026CPT.07.15.20791	Rockingham	17	SR-2308 / BALD HILL LP	FROM NC 704 TO SR 2319 - BAGGAGE RD	2	1.880	20	0.000	1.880	73	63	3.64	34		708		2,137	139		22,277	7,352		752	75	0.27								
TOTAL FOR MAP NO. 17						1.880				73	63	3.64	34		708		2,137	139		22,277	7,352		752	75	0.27								
2026CPT.07.15.20791	Rockingham	18	SR-2540 / WALKER ST	FROM UHLESS ST TO END MAINT	3	0.490	21	0.220	0.710								5,858	84															
TOTAL FOR MAP NO. 18						0.490												5,858	84														
2026CPT.07.15.20791	Rockingham	19	SR-1974 / TOWN CREEK RD	FROM SR 2039 - BETHLEHEM CHURCH RD TO NC 14	2	0.550	21	0.000	0.550	21	9	1.03	10		408		632	42	22	6,582	2,172		220	22	0.08								
TOTAL FOR MAP NO. 19						0.550				21	9	1.03	10		408		632	42	22	6,582	2,172		220	22	0.08								
TOTAL FOR PROJ NO. 2026CPT.07.15.20791						10.060				655	390	18.30	683	5,858	5,059	3,981	12,506	1,013	499	119,820	39,541	1	3,828	384	2.38	441	1.00	67,600	60,600	50	1		
GRAND TOTAL						10.060				655	390	18.30	683	5,858	5,059	3,981	12,506	1,013	499	119,820	39,541	1	3,828	384	2.38	441	1.00	67,600	60,600	50	1		